



Office / Warehouse Space for Lease

**26612-26405 FALLBROOK AVENUE
WYOMING, MN 55092**

Property Overview:

Various office/warehouse spaces and layouts available for lease in the Hallberg Marine Industrial Park located in Wyoming, Minnesota.

Property Highlights:

- Excellent visibility and access to I-35 with over 39,000 vehicles per day
- Local, on-site ownership and management
- Spaces are available beginning October 1, 2022
- Outdoor storage opportunities
- Building signage available
- Dock and drive-in loading
- Ample parking

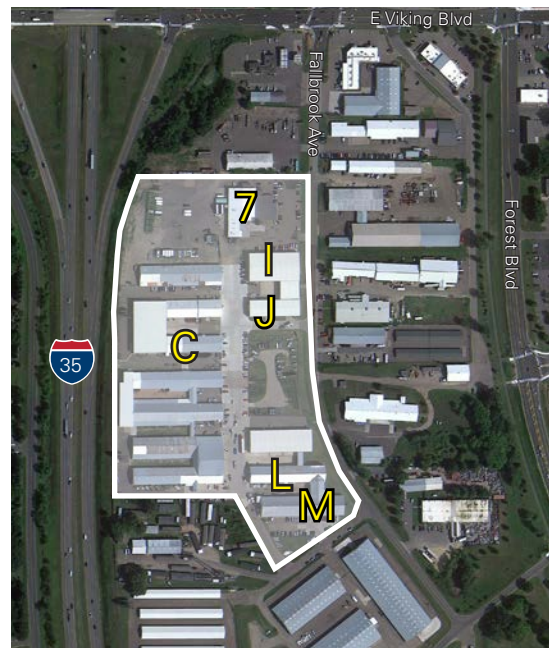

Building Key

For information, please contact:

Dan Friedner

Senior Managing Director

t 612-430-9991

dan.friedner@nmrk.com

Jay Chmielewski

Senior Managing Director

t 612-430-9982

jay.chmielewski@nmrk.com

Patrick Cullen

Associate Director

t 612-430-9995

patrick.cullen@nmrk.com

100 South Fifth St, Suite 2100
Minneapolis, MN 55402

nmrk.com

NEWMARK

The information contained herein has been obtained from sources deemed reliable but has not been verified and no guarantee, warranty or representation, either express or implied, is made with respect to such information. Terms of sale or lease and availability are subject to change or withdrawal without notice.

Building 7 Overview:

Address:

26612 Fallbrook Avenue
Wyoming, MN 55092

Available Space:

6,000 Sq. Ft. - Office
17,600 Sq. Ft. - Warehouse
23,600 Sq. Ft. - Total

Loading:

Five (5) Drive-In Doors
One (1) Dock Door

Outdoor Storage:

2.27 AC

Clear Height:

12' to 14'

Power:

240/120 3-Phase 600amp

Lease Rates:

\$8.75 Per Sq. Ft. - Office
\$4.25 Per Sq. Ft. - Warehouse
\$0.50 Per Sq. Ft. Gross- Outdoor Storage

2022 Est. CAM/Tax:

\$1.65 Per Sq. Ft.



For information, please contact:

Dan Friedner

Senior Managing Director
t 612-430-9991
dan.friedner@nmrk.com

Jay Chmielewski

Senior Managing Director
t 612-430-9982
jay.chmielewski@nmrk.com

Patrick Cullen

Associate Director
t 612-430-9995
patrick.cullen@nmrk.com

100 South Fifth St, Suite 2100
Minneapolis, MN 55402

nmrk.com

BUILDING 7 FLOOR PLAN

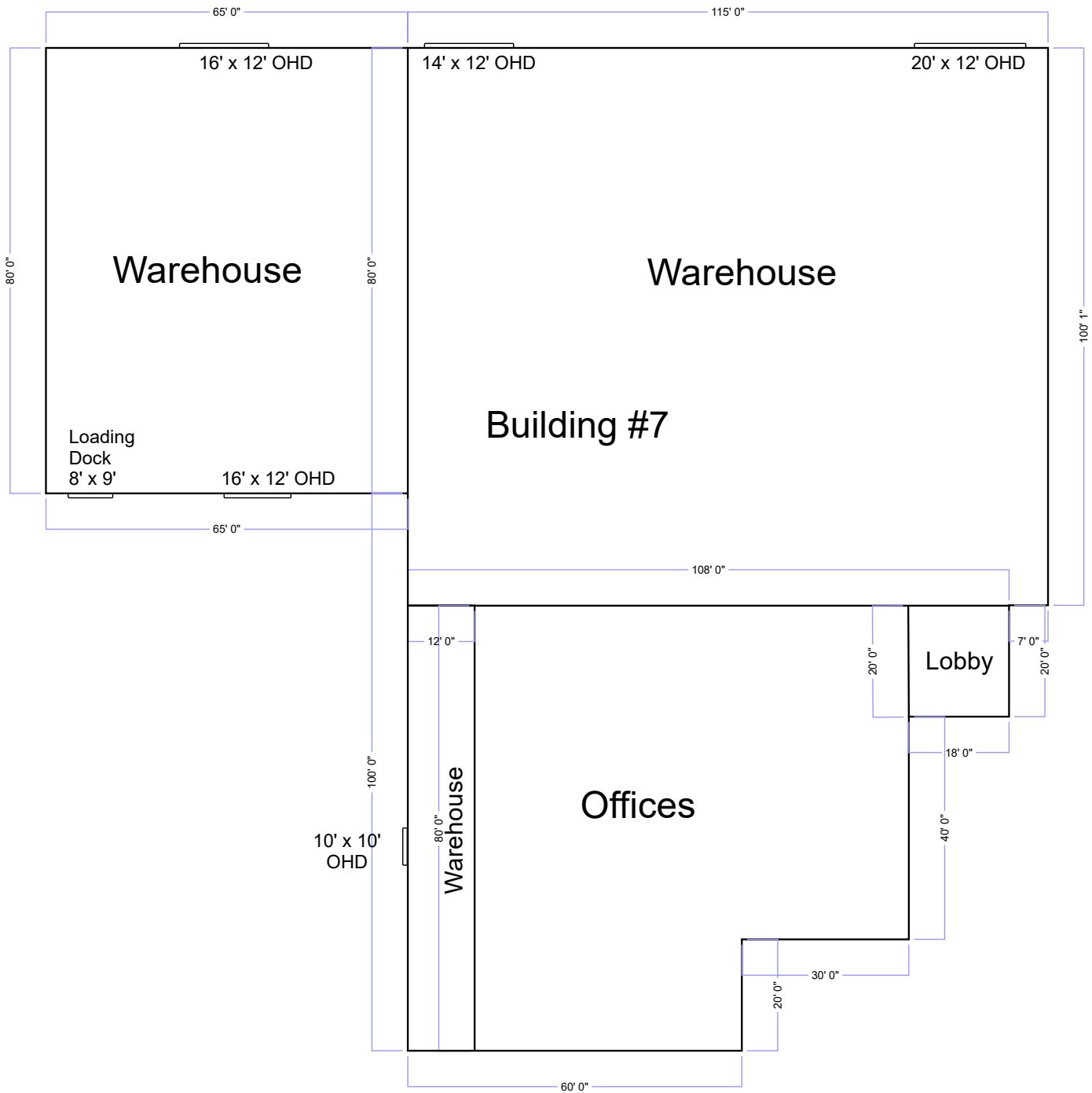

For information, please contact:

Dan Friedner
Senior Managing Director
t 612-430-9991
dan.friedner@nmrk.com

Jay Chmielewski
Senior Managing Director
t 612-430-9982
jay.chmielewski@nmrk.com

Patrick Cullen
Associate Director
t 612-430-9995
patrick.cullen@nmrk.com

100 South Fifth St, Suite 2100
Minneapolis, MN 55402

nmrk.com

26112-26405 FALLBROOK AVENUE | WYOMING, MN 55092

Building C Overview:

Property Address:

26518 Fallbrook Avenue
Wyoming, MN 55092

Available Space:

420 Sq. Ft. - Office
11,880 Sq. Ft. - Warehouse
12,300 Sq. Ft. - Total

Loading:

Two (2) Drive-In Doors

Parking:

18 Parking Stalls
More Parking Available if Needed

Clear Height:

14'

Power:

208/120 3-Phase 600amp

Lease Rates:

\$8.00 Per Sq. Ft. - Office
\$4.00 Per Sq. Ft. - Warehouse

2022 Est. CAM/Tax:

\$1.93 Per Sq. Ft.



For information, please contact:

Dan Friedner

Senior Managing Director
t 612-430-9991
dan.friedner@nrmk.com

Jay Chmielecki

Senior Managing Director
t 612-430-9982
jay.chmielecki@nrmk.com

Patrick Cullen

Associate Director
t 612-430-9995
patrick.cullen@nrmk.com

100 South Fifth St, Suite 2100
Minneapolis, MN 55402

nrmk.com

NEWMARK

The information contained herein has been obtained from sources deemed reliable but has not been verified and no guarantee, warranty or representation, either express or implied, is made with respect to such information. Terms of sale or lease and availability are subject to change or withdrawal without notice.

BUILDING C FLOOR PLAN

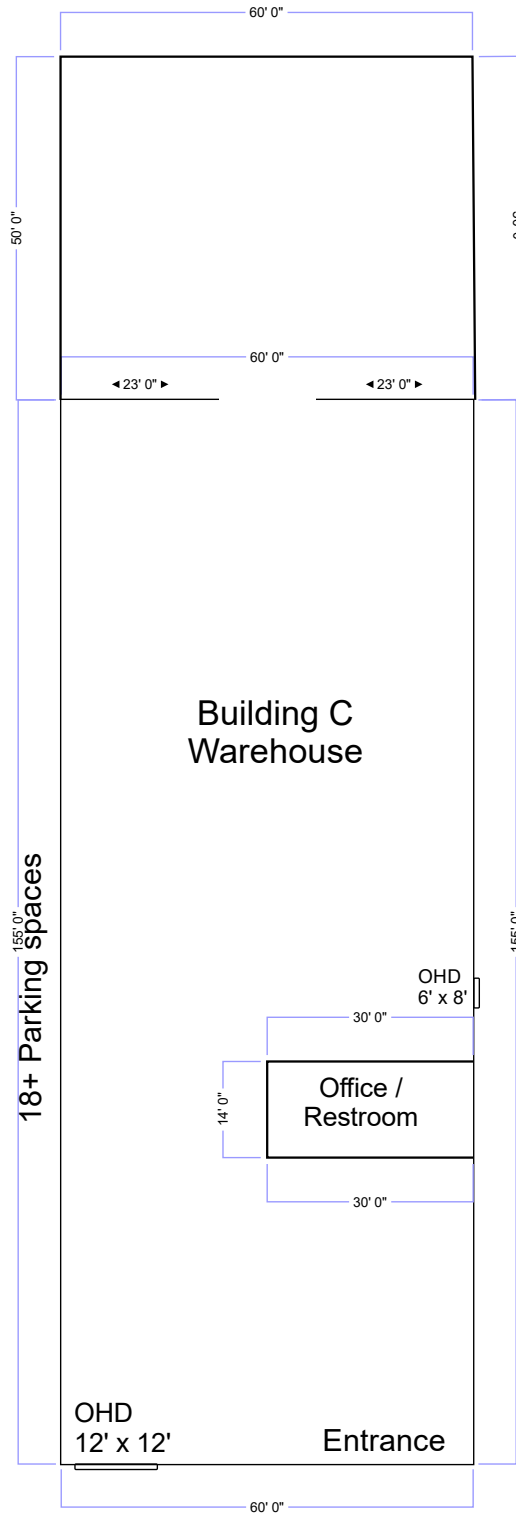

For information, please contact:

Dan Friedner
Senior Managing Director
t 612-430-9991
dan.friedner@nmrk.com

Jay Chmielewski
Senior Managing Director
t 612-430-9982
jay.chmielewski@nmrk.com

Patrick Cullen
Associate Director
t 612-430-9995
patrick.cullen@nmrk.com

100 South Fifth St, Suite 2100
Minneapolis, MN 55402

nmrk.com

26612-26405 FALLBROOK AVENUE | WYOMING, MN 55092

Buildings I&J Overview:

Building I Property Address:

26563 Fallbrook Avenue
Wyoming, MN 55092

Building I Available Space:

3,212 Sq. Ft. - Office
17,396 Sq. Ft. - Warehouse
20,608 Sq. Ft. - Total

Building I Loading:

Two (2) Drive-In Doors
Two (2) Dock Doors

Building I Parking:

27 Parking Stalls
More Parking Available if Needed

////////////////////

Building J Property Address:

26539 Fallbrook Avenue
Wyoming, MN 55092

Building J Available Space:

320 Sq. Ft. - Office
10,720 Sq. Ft. - Warehouse
11,040 Sq. Ft. - Total

Building J Loading:

Three (3) Drive-In Doors
Two (2) Dock Doors

////////////////////

Buildings I&J Clear Height:

18' to 20'

Buildings I&J Shared Loading:

Five (5) Drive-In Doors
Four (4) Dock Doors

Buildings I&J Power:

480/277 3-Phase, 2,000amp with 208/120 3-Phase



Lease Rates:

\$8.75 Per Sq. Ft. - Office
\$4.95 Per Sq. Ft. - Warehouse

2022 Est. CAM/Tax:

\$2.25 Per Sq. Ft.

Property Highlights:

- Buildings are sprinklered
- Divisible to 11,040 square feet or 20,608 square feet
- Buildings can be combined to 31,648 square feet total

For information, please contact:

Dan Friedner

Senior Managing Director
t 612-430-9991
dan.friedner@nrmk.com

Jay Chmielewski

Senior Managing Director
t 612-430-9982
jay.chmielewski@nrmk.com

Patrick Cullen

Associate Director
t 612-430-9995
patrick.cullen@nrmk.com

100 South Fifth St, Suite 2100
Minneapolis, MN 55402

nrmk.com

NEWMARK

The information contained herein has been obtained from sources deemed reliable but has not been verified and no guarantee, warranty or representation, either express or implied, is made with respect to such information. Terms of sale or lease and availability are subject to change or withdrawal without notice.

BUILDINGS I&J FLOOR PLAN

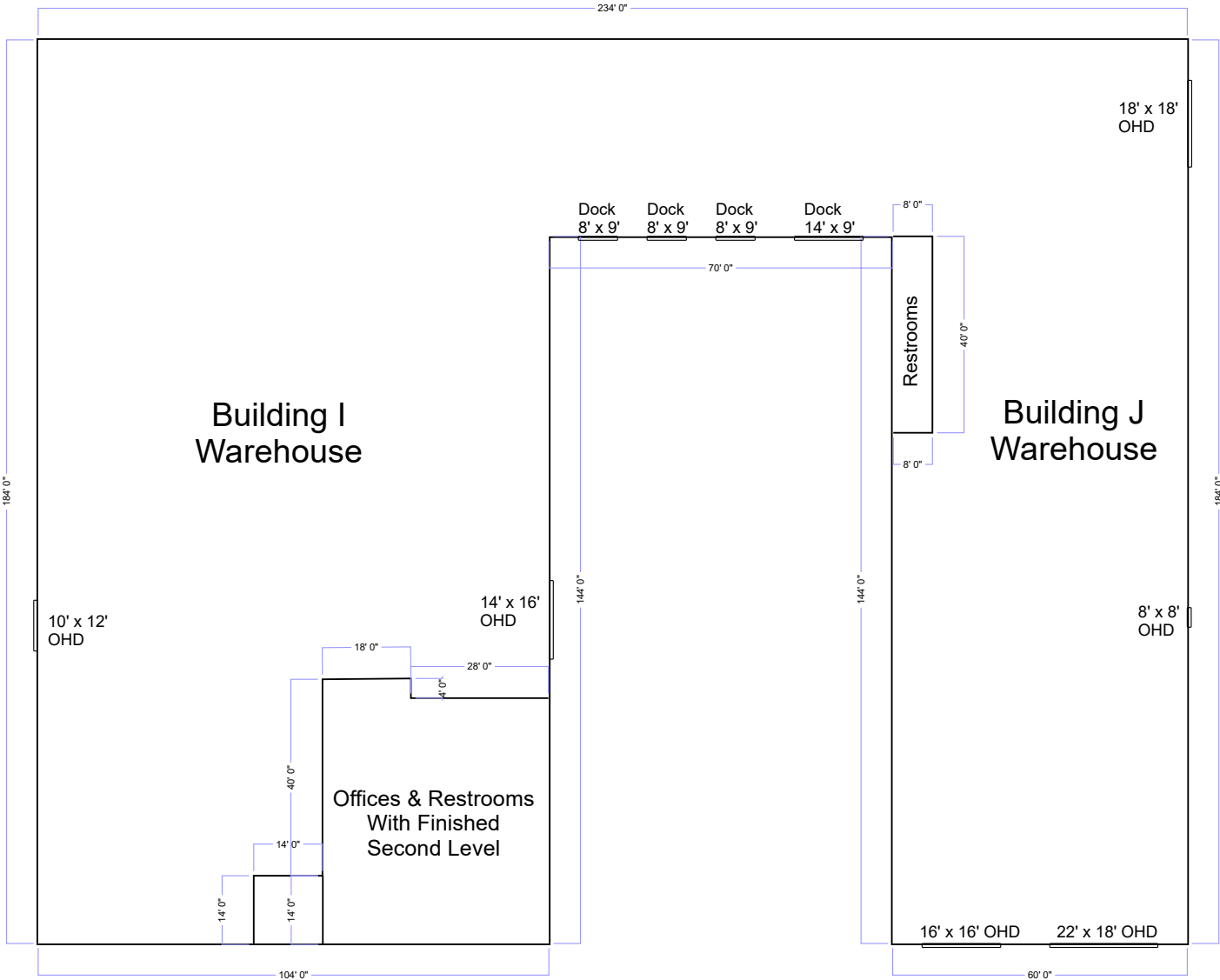

For information, please contact:

Dan Friedner
Senior Managing Director
t 612-430-9991
dan.friedner@nmrk.com

Jay Chmielecki
Senior Managing Director
t 612-430-9982
jay.chmielecki@nmrk.com

Patrick Cullen
Associate Director
t 612-430-9995
patrick.cullen@nmrk.com

100 South Fifth St, Suite 2100
Minneapolis, MN 55402

nmrk.com

26612-26405 FALLBROOK AVENUE | WYOMING, MN 55092

Buildings L&M Overview:

Building L Property Address:

26429 Fallbrook Avenue
Wyoming, MN 55092

Building L Available Space:

200 Sq. Ft.- Restrooms
16,300 Sq. Ft.- Warehouse
16,500 Sq. Ft. - Total

Building L Loading:

One (1) Drive-In Door
Three (3) Dock Doors

Building L Parking:

Parking Available if Needed

Building L Clear Height:

15'

Building L Power:

208/120 3-Phase 400amp

////////////////////

Building M Property Address:

26405 Fallbrook Avenue
Wyoming, MN 55092

Building M Available Space:

2,350 Sq. Ft.- Office
19,000 Sq. Ft.- Warehouse
21,350 Sq. Ft. - Total

Building M Loading:

Two (2) Drive-In Doors

Building M Parking:

42 Parking Stalls

Building M Outdoor Storage:

Approx. 0.21 AC

Building M Clear Height:

16'

Building M Power:

208/120 3-Phase 600amp



Lease Rates:

\$7.75 Per Sq. Ft.- Office
\$3.75 Per Sq. Ft.- Warehouse
\$0.50 Per Sq. Ft. Gross- Outdoor Storage

2022 Est. CAM/Tax:

\$2.05 Per Sq. Ft.

Buildings L&M Shared Loading:

Three (3) Drive-In Doors
Three (3) Dock Doors

Property Highlights:

- Divisible to 16,500 square feet or 21,350 square feet
- Buildings can be combined to 37,850 square feet total

////////////////////

For information, please contact:

Dan Friedner

Senior Managing Director
t 612-430-9991
dan.friedner@nmrk.com

Jay Chmielewski

Senior Managing Director
t 612-430-9982
jay.chmielewski@nmrk.com

Patrick Cullen

Associate Director
t 612-430-9995
patrick.cullen@nmrk.com

100 South Fifth St, Suite 2100
Minneapolis, MN 55402

nmrk.com

NEWMARK

The information contained herein has been obtained from sources deemed reliable but has not been verified and no guarantee, warranty or representation, either express or implied, is made with respect to such information. Terms of sale or lease and availability are subject to change or withdrawal without notice.

BUILDINGS L&M FLOOR PLAN

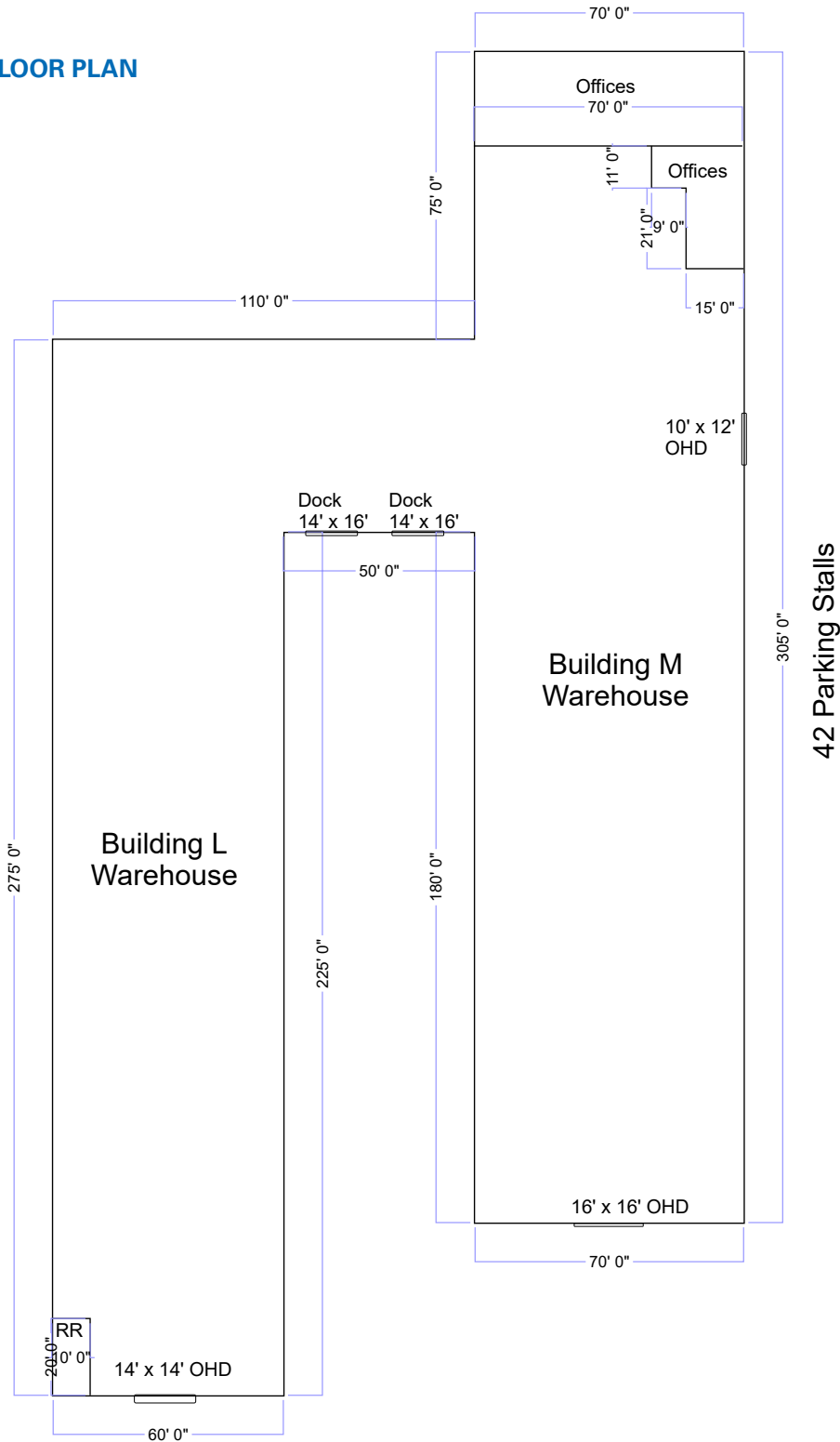

For information, please contact:

Dan Friedner
Senior Managing Director
t 612-430-9991
dan.friedner@nmrk.com

Jay Chmielecki
Senior Managing Director
t 612-430-9982
jay.chmielecki@nmrk.com

Patrick Cullen
Associate Director
t 612-430-9995
patrick.cullen@nmrk.com

100 South Fifth St, Suite 2100
Minneapolis, MN 55402

nmrk.com



For information, please contact:

Dan Friedner
Senior Managing Director
t 612-430-9991
dan.friedner@nmrk.com

Jay Chmielecki
Senior Managing Director
t 612-430-9982
jay.chmielecki@nmrk.com

Patrick Cullen
Associate Director
t 612-430-9995
patrick.cullen@nmrk.com

100 South Fifth St, Suite 2100
Minneapolis, MN 55402

nmrk.com

NEWMARK

The information contained herein has been obtained from sources deemed reliable but has not been verified and no guarantee, warranty or representation, either express or implied, is made with respect to such information. Terms of sale or lease and availability are subject to change or withdrawal without notice.

26612-26405 FALLBROOK AVENUE | WYOMING, MN 55092



For information, please contact:

Dan Friedner
Senior Managing Director
t 612-430-9991
dan.friedner@nmrk.com

Jay Chmielecki
Senior Managing Director
t 612-430-9982
jay.chmielecki@nmrk.com

Patrick Cullen
Associate Director
t 612-430-9995
patrick.cullen@nmrk.com

100 South Fifth St, Suite 2100
Minneapolis, MN 55402

nmrk.com

NEWMARK

The information contained herein has been obtained from sources deemed reliable but has not been verified and no guarantee, warranty or representation, either express or implied, is made with respect to such information. Terms of sale or lease and availability are subject to change or withdrawal without notice.

26612-26405 FALLBROOK AVENUE | WYOMING, MN 55092



For information, please contact:

Dan Friedner
Senior Managing Director
t 612-430-9991
dan.friedner@nmrk.com

Jay Chmielecki
Senior Managing Director
t 612-430-9982
jay.chmielecki@nmrk.com

Patrick Cullen
Associate Director
t 612-430-9995
patrick.cullen@nmrk.com

100 South Fifth St, Suite 2100
Minneapolis, MN 55402

nmrk.com

NEWMARK

The information contained herein has been obtained from sources deemed reliable but has not been verified and no guarantee, warranty or representation, either express or implied, is made with respect to such information. Terms of sale or lease and availability are subject to change or withdrawal without notice.